

MALDIVES LAND SURVEY AUTHORITY

MINISTRY OF HOUSING AND INFRASTRUCTURE
 Office (PABX): +(960) 3004300, Fax: +(960) 3004254
 Email: survey@housing.gov.mv
 Web: www.surveyofmaldives.gov.mv,
 Ameenee Magu, Maafannu, Male', 20392, Maldives.



CONTROL POINT DETAILS	Station Number	PSM 5702
Coordinate Information		
Geodetic	Grid	
WGS 84	UTM Zone 43	
Lat: 4°22'48.83121"N	E:	351952.067 m
Long: 73°39'56.80506"E	N:	484288.253 m
Ellp Height: -41.510	Orth Height:	+1.350m
Island Name: VILLINGILIMATHIDHAHURAA (LD0215)	Date:	12th March 2021

Monument description & method of survey:

- Monument Type A as in Technical Brief
- Stainless steel plate fixed to concrete by Four bolts
- Horizontal coordinates fixed by GNSS Static survey.
- Vertical height corrected using tide prediction data (Hulhule)
- **PSM 5702 is 100mm below ground Level**

General site condition & access:

- Easily accessible area with wide angle of sky visibility
- No infrastructure in 30m radius build near this PSM at the time of survey.
- Located in North side of the island (in front of proposed Chedi Club (30m North East)
- 13.2m far away from High tide line from east side.

Owner: MFAR Kudavillingili Pvt Ltd.

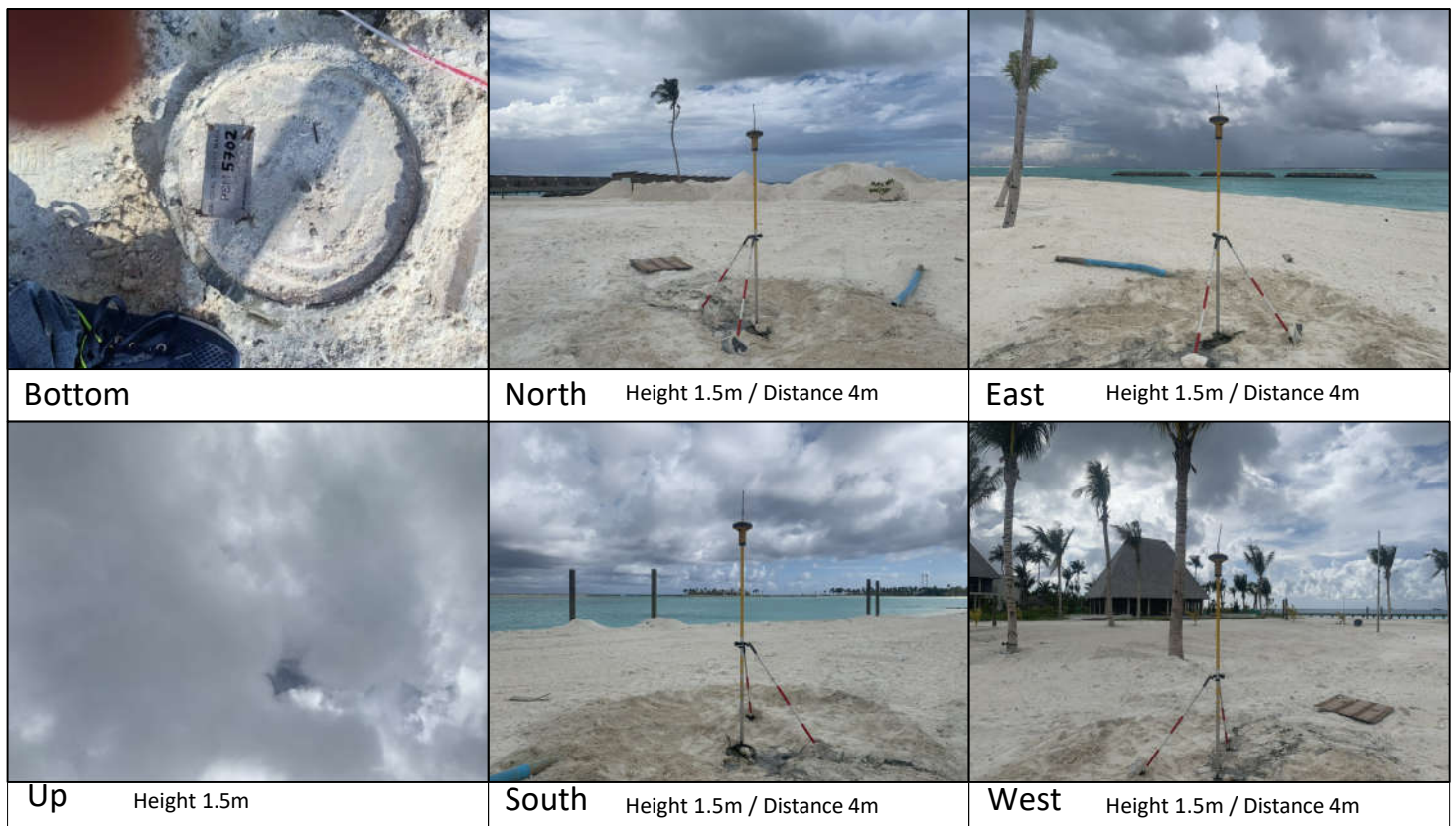

SITE INFORMATION

Station Number

P	S	M	5	7	0	2
---	---	---	---	---	---	---

Station Horizon Mask

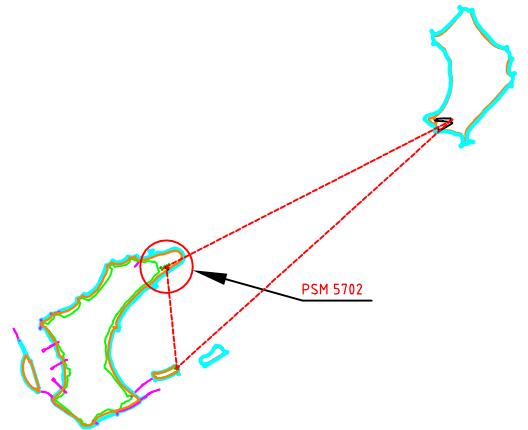
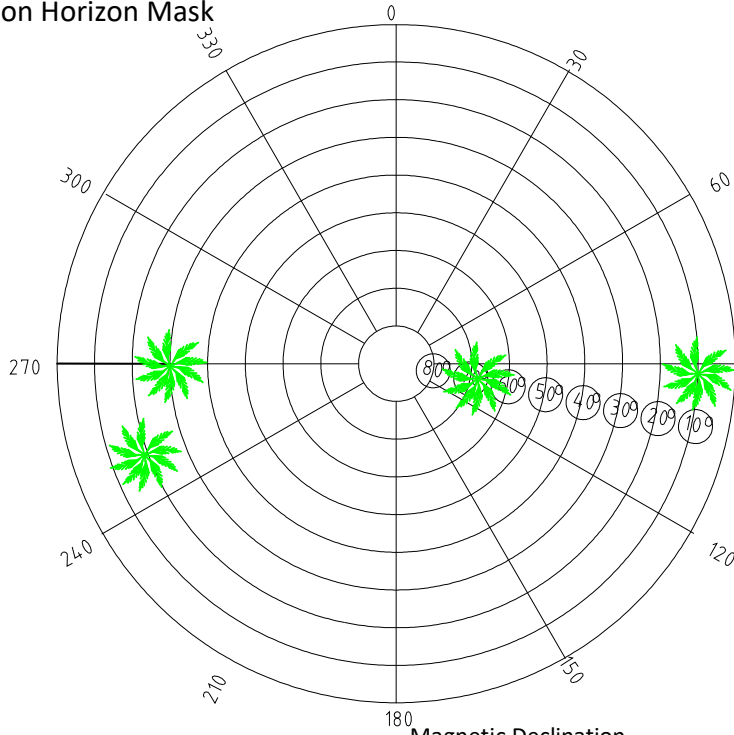

Height above Marker that horizon was mapped from 1.5 m

Magnetic Declination _____
 Declination applied to this figure?
 Yes No

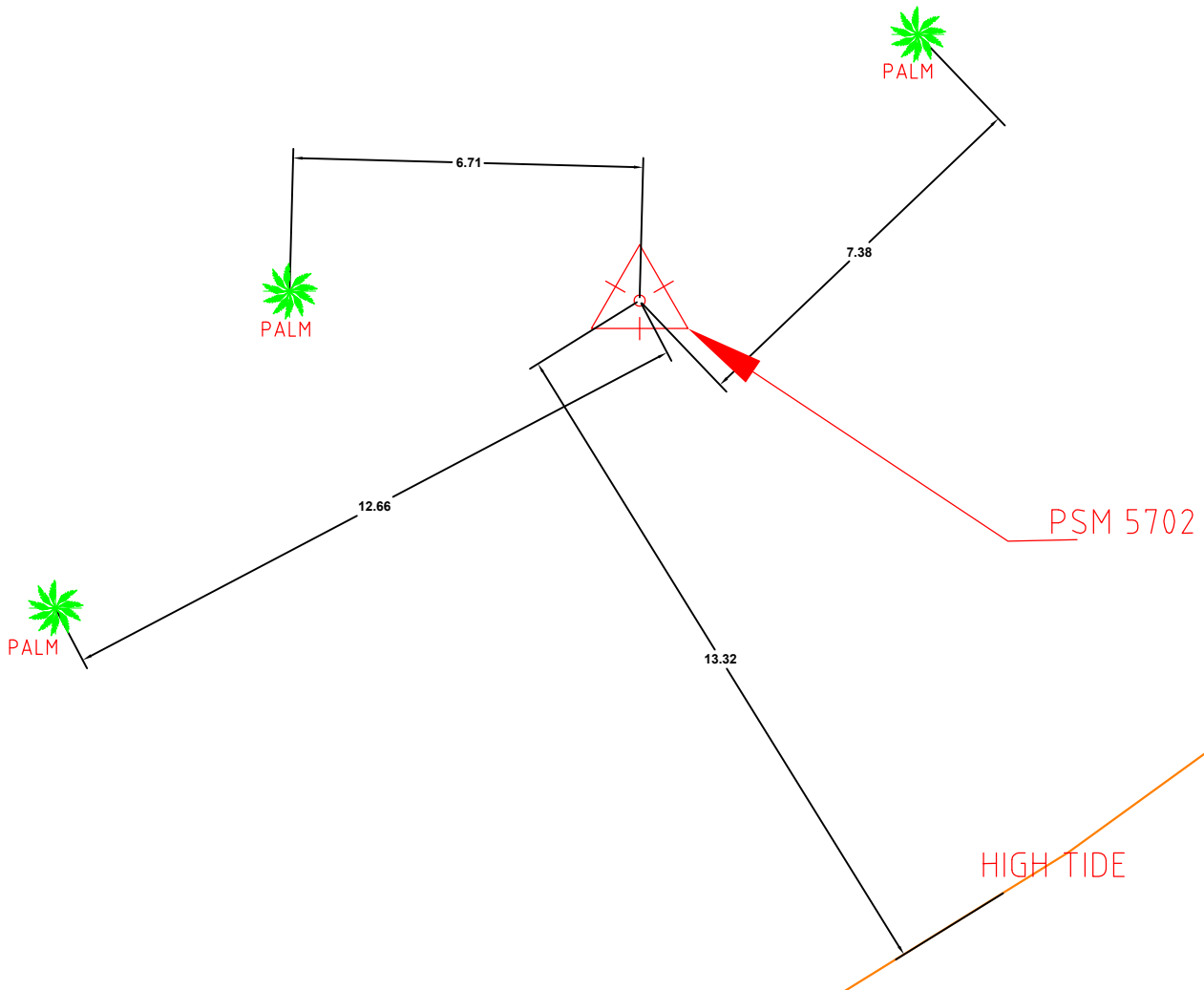

Sketched by: Abulho

Scale: Not to Scale

Date: 12th March 2021

MALDIVES LAND SURVEY AUTHORITY

MINISTRY OF HOUSING AND INFRASTRUCTURE
Office (PABX): +(960) 3004300, Fax: +(960) 3004254
Email: survey@housing.gov.mv
Web: www.surveyofmaldives.gov.mv,
Ameenee Magu, Maafannu, Male', 20392, Maldives.



CONTROL POINT DETAILS	Station Number	PSM 5703
Coordinate Information		
Geodetic	Grid	
WGS 84	UTM Zone 43	
Lat: 4°22'35.12565"N	E: 351995.478 m	
Long: 73°39'58.23748"E	N: 483867.238 m	
Ellp Height: -41.518	Orth Height: +1.342m	
Island Name: LD1765	Date: 12th March 2021	

Monument description & method of survey:

- Monument Type A as in Technical Brief
- Stainless steel plate fixed to concrete by Four bolts
- Horizontal coordinates fixed by GNSS Static survey.
- Elevation reduced relative to ellipsoid height difference reference to PSM 5702 which was corrected to Meanwater level by tide prediction table.
- **PSM 5703 is 50mm Above ground Level**

General site condition & access:

- Easily accessible area with wide angle of sky visibility
- Located in North East side of the island
- Near Edge of the Rock Boulder Crest - approx 1.6m away.

Owner: MFAR Kudavillingili Pvt Ltd.

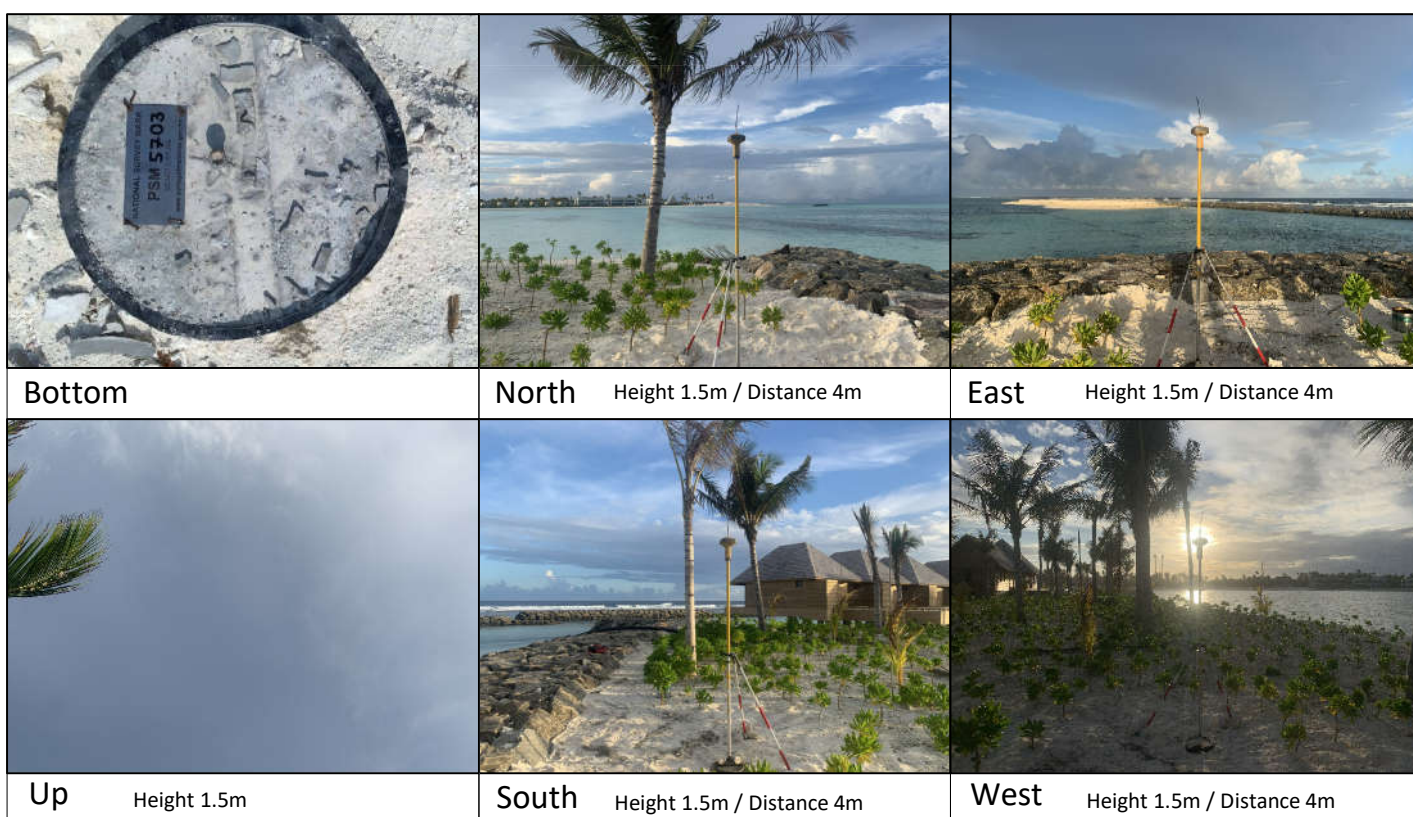

SITE INFORMATION

Station Number

P	S	M	5	7	0	3
---	---	---	---	---	---	---

Station Horizon Mask

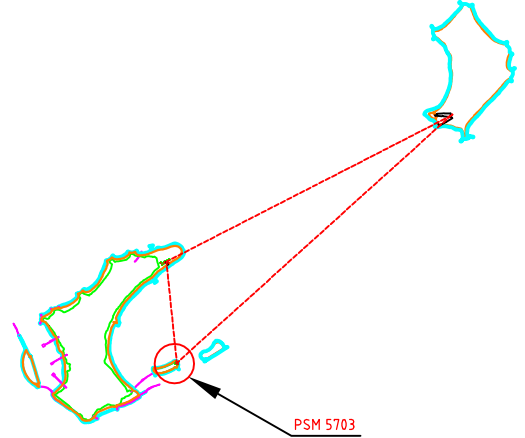
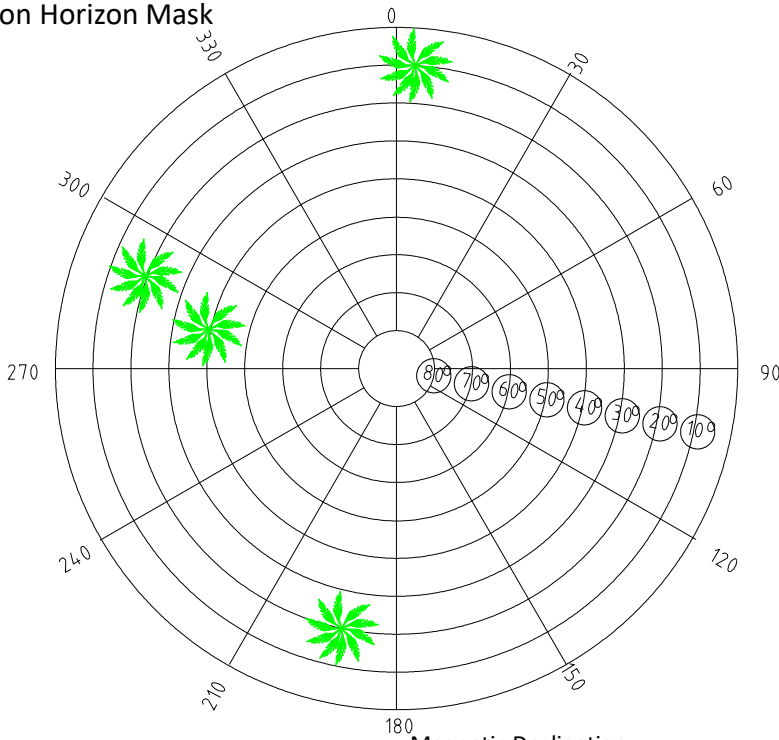

Height above Marker that horizon was mapped from: 1.5 m

Magnetic Declination _____
 Declination applied to this figure?
 Yes No

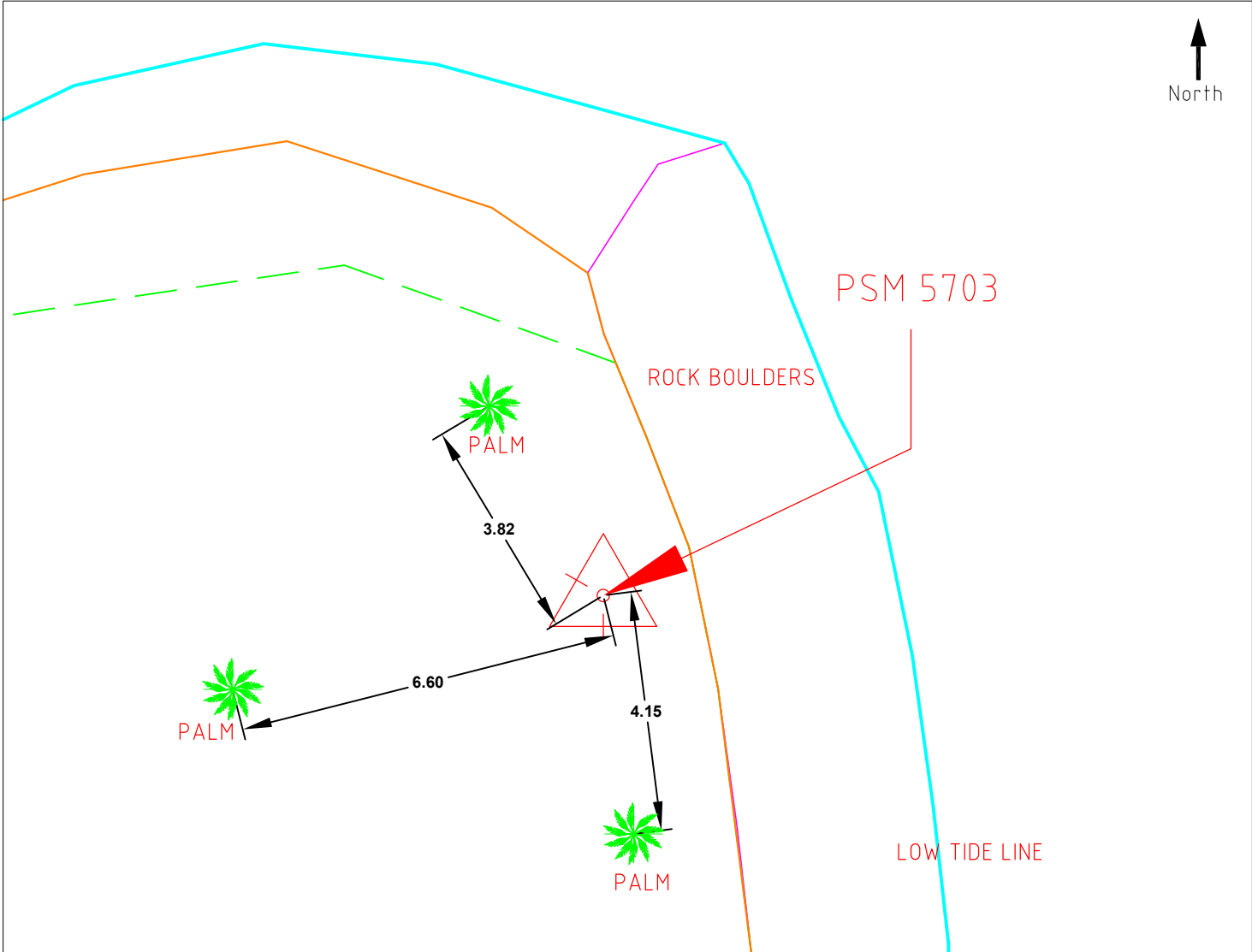

Sketched by: Abulho

Scale: Not to Scale

Date: 12th March 2021

MALDIVES LAND SURVEY AUTHORITY

MINISTRY OF HOUSING AND INFRASTRUCTURE
 Office (PABX): +(960) 3004300, Fax: +(960) 3004254
 Email: survey@housing.gov.mv
 Web: www.surveyofmaldives.gov.mv,
 Ameenee Magu, Maafannu, Male', 20392, Maldives.



CONTROL POINT DETAILS	Station Number	PSM 5704
Coordinate Information		
Geodetic	Grid	
WGS 84	UTM Zone 43	
Lat: 4°23'08.63414"N	E:	353134.306 m
Long: 73°40'35.11940"E	N:	484894.363 m
Ellp Height: -41.604	Orth Height:	+1.256
Island Name: LD1710	Date:	12th March 2021

Monument description & method of survey:

- Monument Type A as in Technical Brief
- Stainless steel plate fixed to concrete by Four bolts
- Horizontal coordinates fixed by GNSS Static survey.
- Elevation reduced relative to ellipsoid height difference , reference to PSM 5702 which was corrected to Meanwater level by tide prediction table (Hulhule)
- **PSM 5704 is 50mm above ground Level**

General site condition & access:

- Easily accessible area with wide angle of sky visibility
- Located in Southern side groyne of the island.
- Approx - 55m away.
- No infrastructure build in this island at the time of survey.

Owner: MFAR Kudavillingili Pvt Ltd.

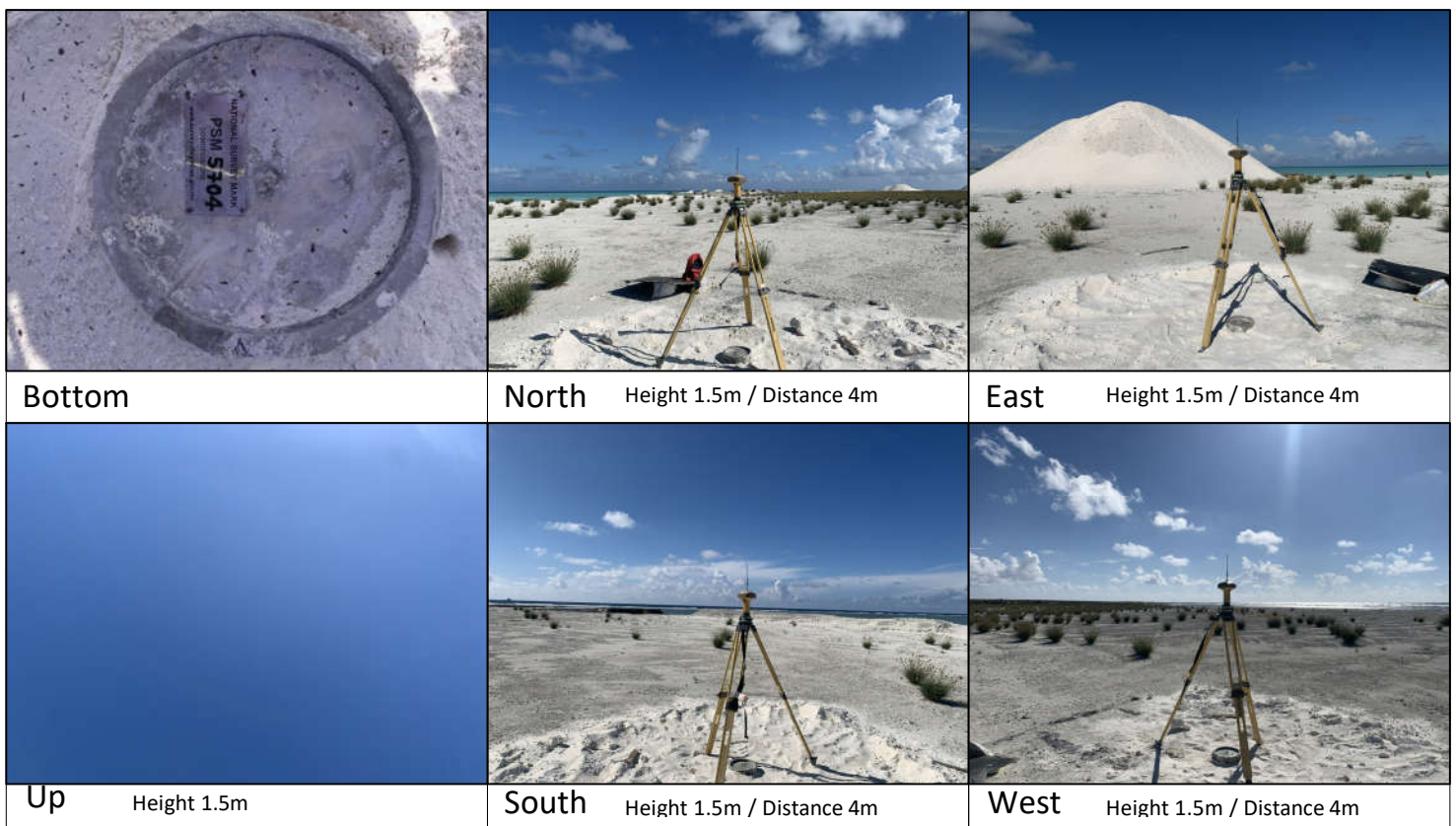

SITE INFORMATION

Station Number

P	S	M	5	7	0	4
---	---	---	---	---	---	---

Station Horizon Mask

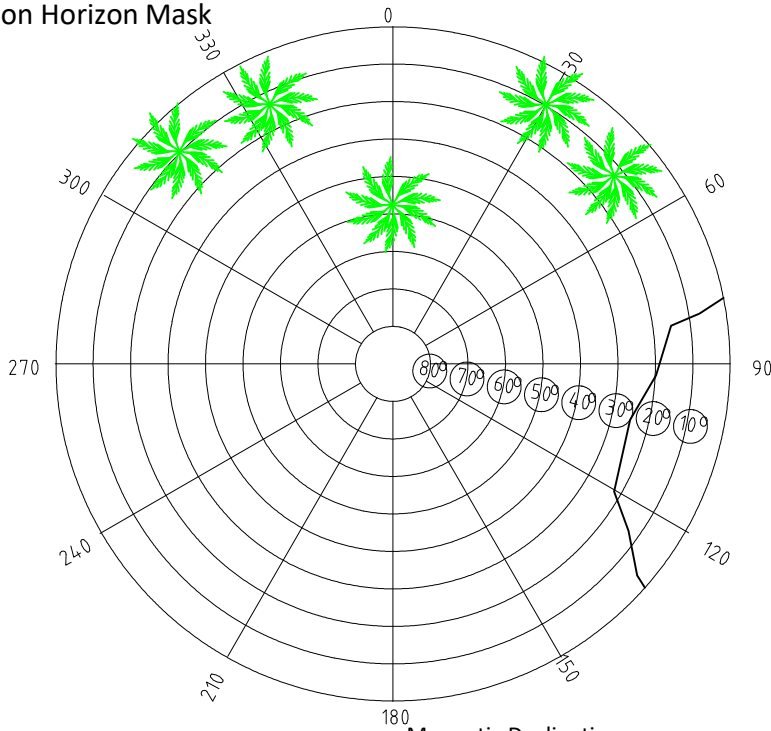

Height above Marker that horizon was manned from 1.5 m

Magnetic Declination _____
 Declination applied to this figure?
 Yes No

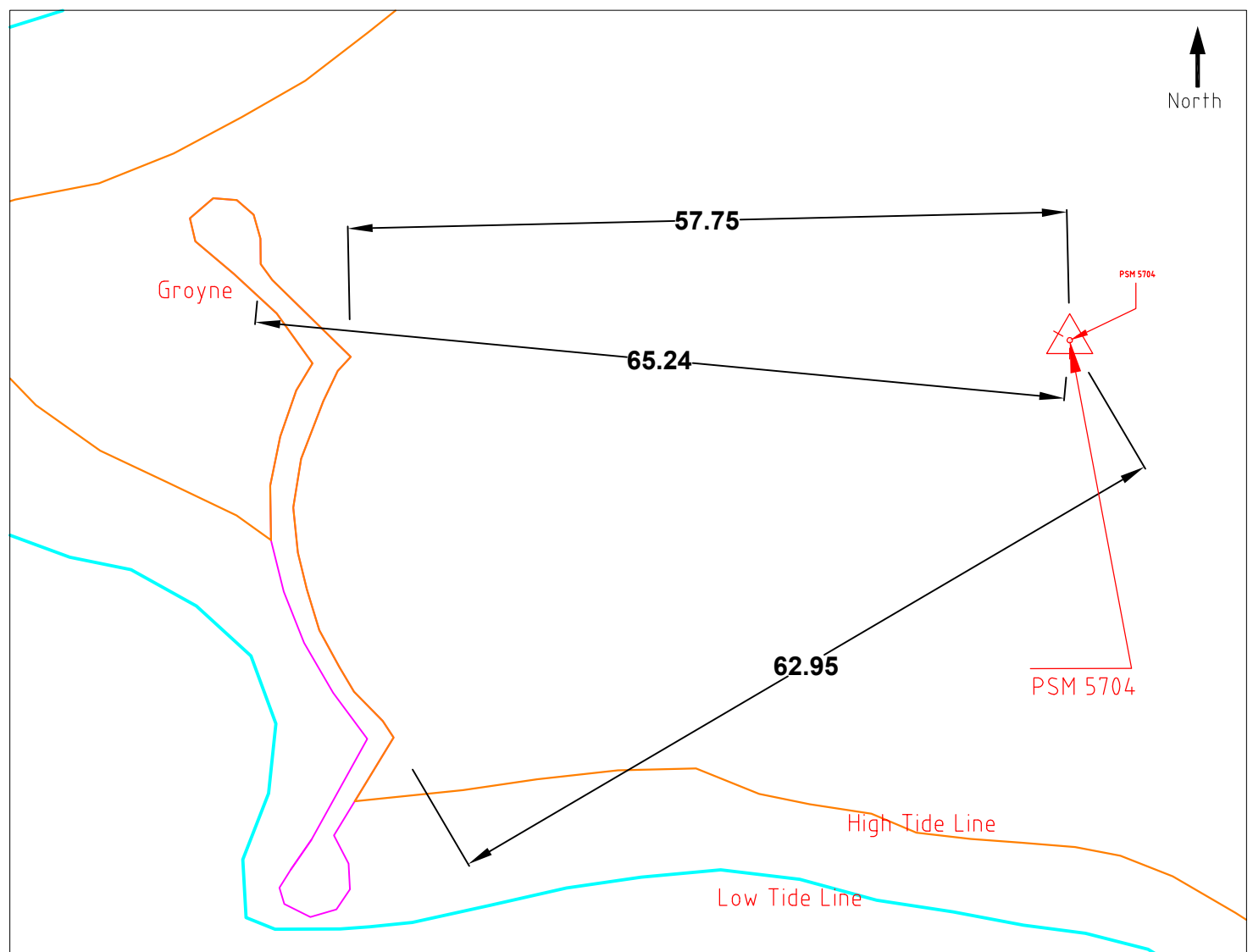
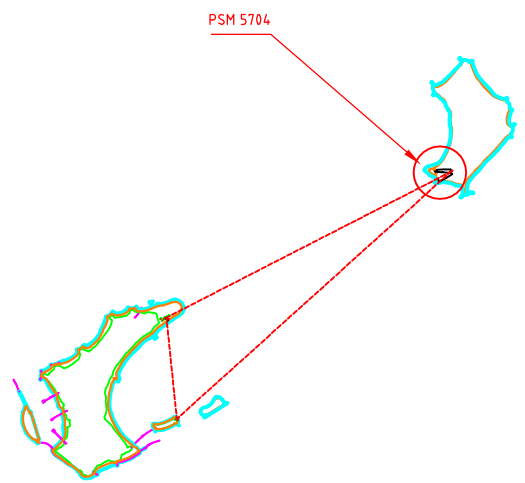

Sketched by: Abulho

Scale: Not to Scale

Date: 12th March 2021